

Top View

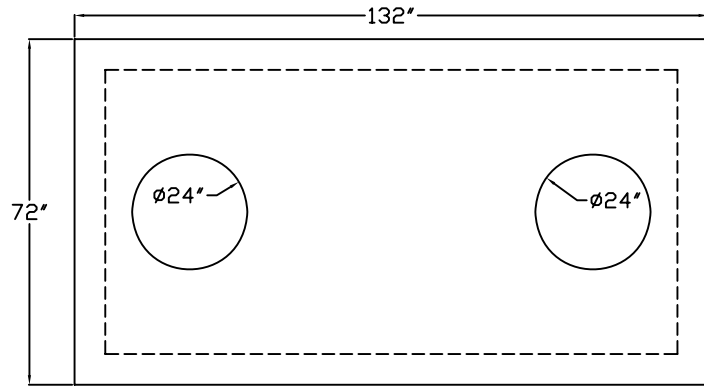

End View

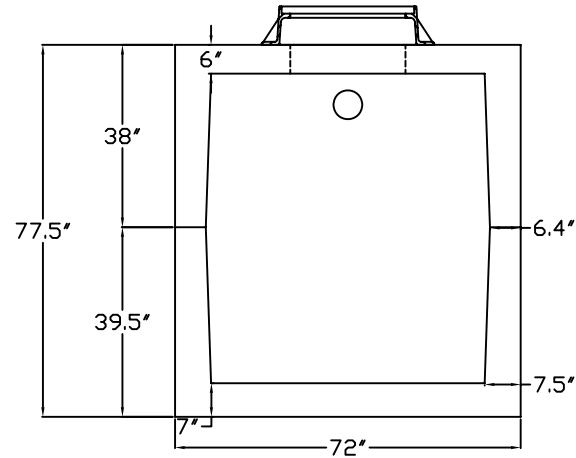

Butyl Sealant ASTM C990 Compliant

Baffle View

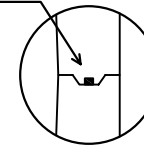

Side View

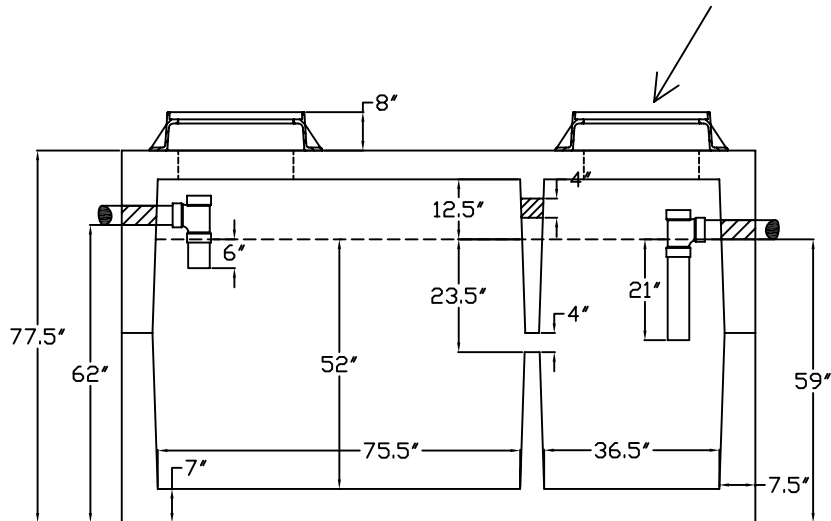

Specifications

Concrete: 5,000 psi minimum strength (28 day)

Structural Performance: The tank meets the design criteria for H-20 bridge loadings and a maximum burial depth of 8'. Structural Engineering design available upon request.

Reinforcing: Primary reinforcement will be according to structural engineer's reinforcement schedule.

Risers: All risers, if required, will be watertight and rated for traffic.

Sealant: Sealant used in the seam of the tank will meet or exceed ASTM C990.

Pipe Penetrations: Inlet and outlets are fitted with seals that meet or exceed all ASTM C923 specifications manufactured by Polylok and Press-Seal Gasket Corporation.

Effluent Filter: All effluent filters, if required, will be a PolyLok PL-68 or other approved filter.

Inlet / Outlet Baffle: The inlet and outlet baffle is a 4" sch. 40 sanitary PVC tee. The tee's will extend approximately within 1" of the inside top of the tank.

Partition Wall: The partition wall, if present, is poured monolithically.

Tank Label: On the end of the tank, above and to the right of the outlet, the company logo and number of gallons will be cast into the tank.

Manufactured by:
C.R. Barger & Sons, Inc.
 238 Mays Valley Road
 Harriman Tn 37748
Phone 865.882.5860 **Fax** 865.882.6394
 www.bargerandsons.com

General Notes:
 All vertical measurements are accurate within ± 1 inch on the tank. The lids can be moved and resized if necessary. Written specifications and engineered drawings are available upon request. Tank is designed for a maximum cover of 8' and H-20 loadings.

Tank Type: Septic H-20 1500 Gallon Two Compart.	
Date: 4.212005	Approx. Weight: 26,000 lbs.
Drawn By: Eric Barger	State: Arkansas