

Top View

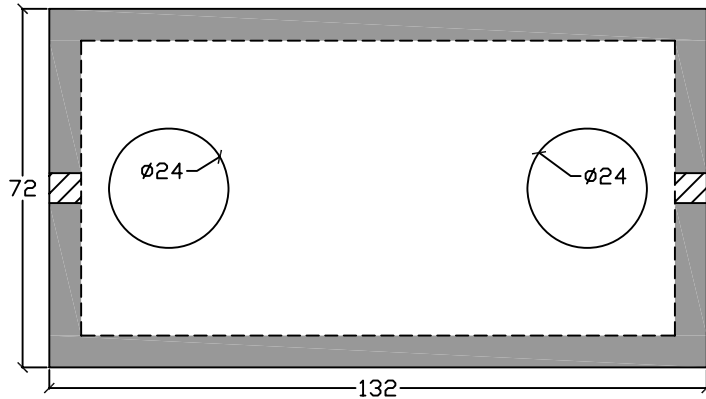

End View

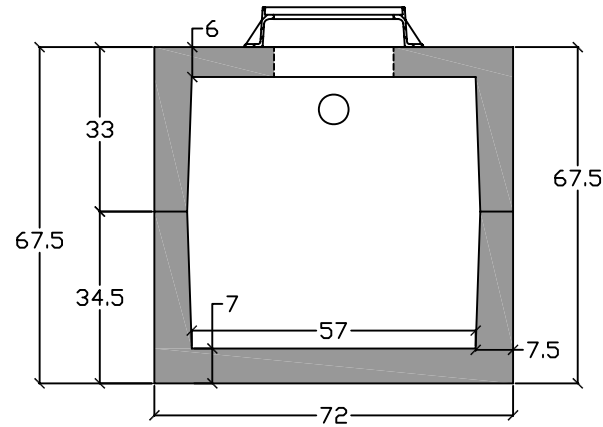

Specifications

Concrete: 5,000 psi minimum strength (28 day)

Reinforcing: Rebar reinforcement is per engineers design. This tank is designed for eight foot of cover and HS20 traffic ratings. Structural engineering drawings stamped by a Licensed Professional Engineer available upon request.

Risers: Grade rings and manhole frames and covers sold separately.

Sealant: Sealant used in the seam of the tank will meet or exceed ASTM C990.

Pipe Penetrations: Inlet and outlets are fitted with seals that meet or exceed all ASTM C923 specifications.

Partition Wall: The partition wall, if present, is poured monolithically.

Installation: The tank hole is not to be more than one foot longer and wider than the tank. There shall be a minimum of 6" of $\frac{3}{4}$ " stone bedding in soil terrain and a 12" stone bedding in rock terrain.

Tank Warranty: The C. R. Barger & Sons, Inc. septic tank when installed in accordance with manufacturer's instructions is warranted against defective materials and/or workmanship for 1 year from the date of delivery to the project site. Should a defect appear within the warranty period, C. R. Barger & Sons, Inc. will supply a new septic tank in replacement thereof. C. R. Barger & Sons, Inc. liability is limited to the value of the septic tank itself and specifically excludes the cost of installation and/or removal and consequential damages.

Failure to comply with C. R. Barger & Sons, Inc. installation procedures and general notes will void warranty.

- ASTM C 1613 compliant
- HS20 traffic rated
- 6" inlet/outlet
- 6" PVC pipe in baffle wall for connection on outlet side



Side View

24" clear opening, H20 Manhole Frame and Cover. Lid is labeled "Grease". Please specify vented or non-vented lid.

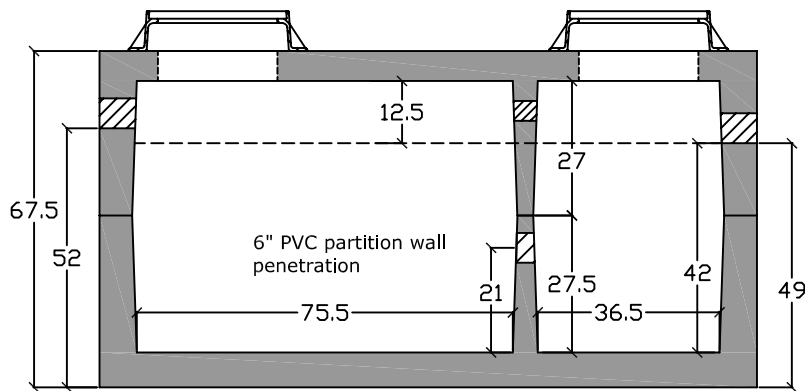

Baffle View

ASTM C990 Sealant

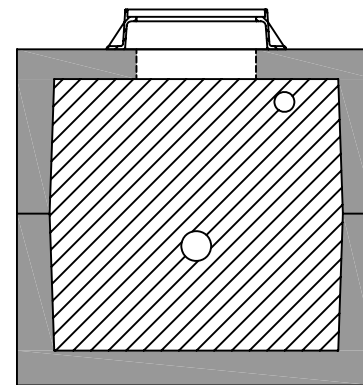
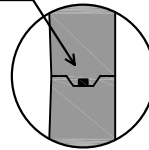

Manufactured by:
C.R. Barger & Sons, Inc.
 123 Pawnook Farm Road
 Lenoir City TN 37771
Phone 865.270.8080 **Fax** 865.270.8079
 www.BargerAndSons.com

General Notes:

All vertical measurements are accurate within ± 1 inch on the tank. The lids can be moved and resized if necessary. Written specifications and engineered drawings are available upon request. Tank is designed for a maximum cover of 8' and HS20 loadings.

Tank Type: **HS20 Grease Trap 1250 Gallon**

Date: **6.282010**

Approx. Weight: **24,000 lbs.**

Drawn By: **Eric Barger**

Utility: **Nashville-Metro**