

Side View

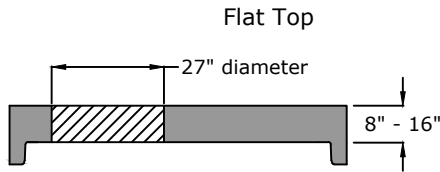

Flat Top

Flat Top	
8"	3,000 lb
10"	3,700 lb
12"	4,400 lb
16"	5,900 lb

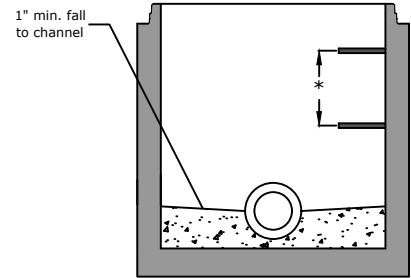

Manhole Base Preformed Invert Detail

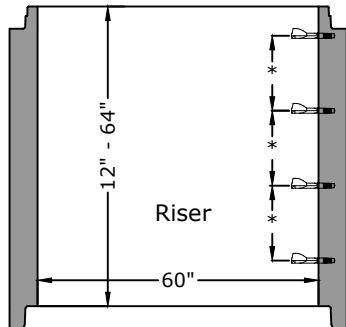

Riser

Riser Weights	
12"	1,300 lb
16"	1,750 lb
24"	2,600 lb
32"	3,450 lb
36"	3,900 lb
48"	5,200 lb
60"	6,500 lb
64"	6,900 lb

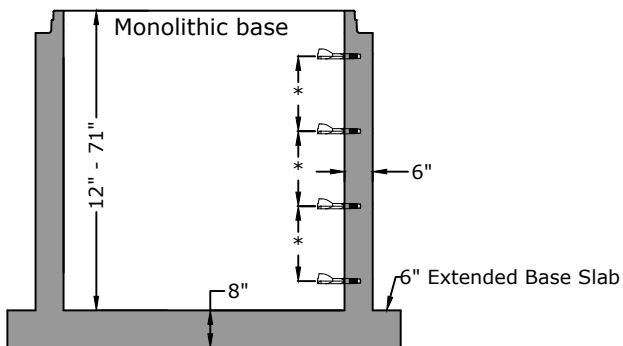

Monolithic base

Base Weights	
12"	5,150 lb
16"	5,600 lb
24"	6,450 lb
32"	7,300 lb
48"	9,050 lb
60"	10,350 lb
64"	10,800 lb
71"	11,550 lb



Approved for Production

Project: _____

Date: _____

Quantity: _____

By: _____

BARGER PRECAST

Specifications

Concrete: 5,000 psi minimum 28 day compressive strength

Reinforcing: Per ASTM C478 with design calculations performed by a Licensed P.E. Minimum 2" cover of all reinforcing steel.

Pipe Penetrations: All pipe penetrations are placed according to job requirements.

Pipe Seals: All pipe boots will meet ASTM C 923.

Sealant: Sealant used will meet ASTM C 990.

Steps: On 16" center unless otherwise specified.

Preformed Invert: As required by plans or governing specifications.

**60" I.D. precast concrete manhole pieces
ASTM C-478 Compliant**

C.R. Barger & Sons, Inc.
P.O. Box 370 - Kingston TN 37763
Phone 888.882.5860 - BargerAndSons.com

Date: 3.072011

Drawn By: Eric Barger

Updated: 11.032022