

Top View

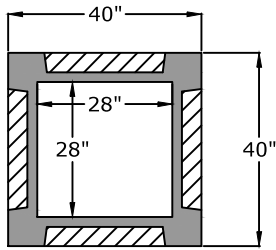

Side View

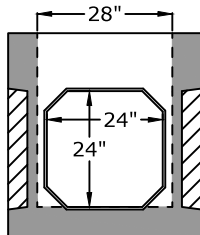

Approved for Production

Project: _____

Date: _____

Quantity: _____

By: _____

BARGER
PRECAST

Specifications

Concrete: 5,000 psi minimum strength (28 day)

Reinforcement: ASTM C 913 Latest Edition

Knock-out panels: All knock-out panels shall be completely filled with non-shrink grout (4,000 psi 28 day).

28" W x 28" W x 32" T
Knock-Out Box

C.R. Barger & Sons, Inc.
P.O. Box 370 - Kingston TN 37763
Phone 888.882.5860 - BargerAndSons.com

Date: 11.222016

Drawn By: Eric Barger

Approx. Vault Weight: 3,400 lb.