

# Top View

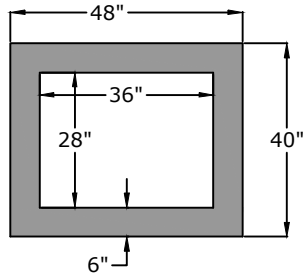

### Inside Height - Weight

- 36" - 4800 lb.
- 40" - 5100 lb.
- 44" - 5420 lb.
- 48" - 5720 lb.

### Top Lid

Height (in.)	Weight (lb.)
8"	2,800

### Base/Riser Combo

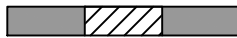

### Riser Weight

Height (in.)	Weight (lb.)
24"	3,700
30"	4,600
36"	5,500
42"	6,500
48"	7,400

### Side View

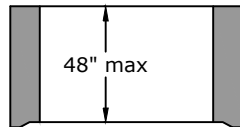

### Base Weight

Height (in.)	Weight (lb.)
24"	6,500
30"	7,400
36"	8,400
42"	9,300
48"	10,100

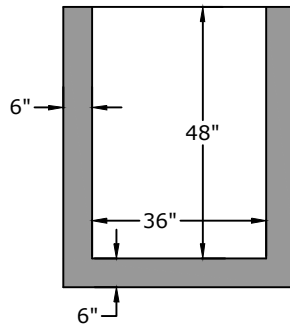
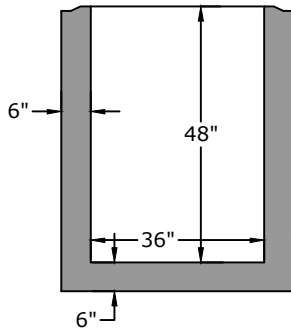

## Approved for Production

Project: \_\_\_\_\_ Date: \_\_\_\_\_

Quantity: \_\_\_\_\_ By: \_\_\_\_\_

# BARGER PRECAST

### Specifications

**Concrete:** 5,000 psi minimum strength (28 day)  
**Reinforcement:** ASTM C 913 Latest Edition

## 28" W x 36" W - Area Drain, Curb Inlet, Catch Basin and General Box

C.R. Barger & Sons, Inc.  
 P.O. Box 370 - Kingston TN 37763  
 Phone 888.882.5860 - BargerAndSons.com

Date: 2.022010

Drawn By: Eric Barger

Last Updated: 10.222021