

### Top View

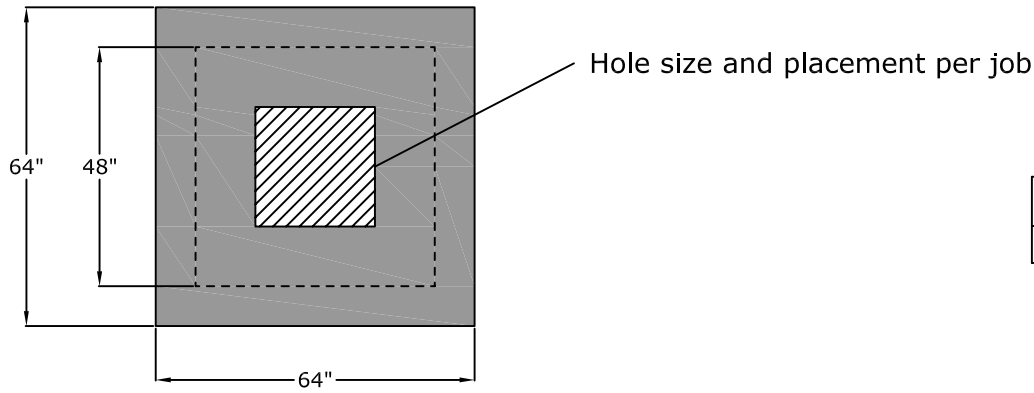

### Top Lid

Height (in.)	Weight (lb.)
8"	2,800

### Riser Weight

Height (in.)	Weight (lb.)
24"	3,700
30"	4,600
36"	5,500
42"	6,500
48"	7,400

### Side View

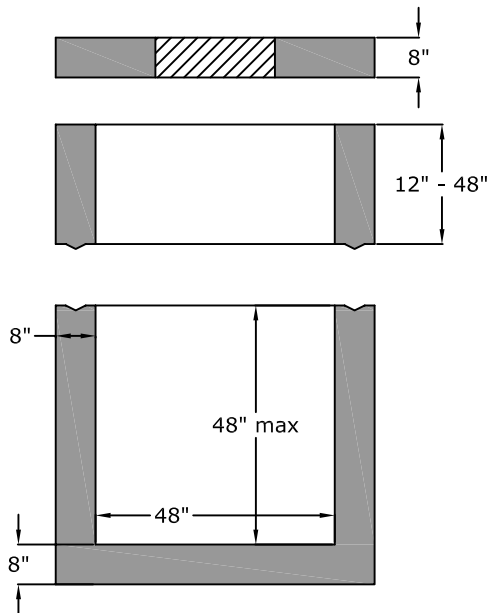

### Base Weight

Height (in.)	Weight (lb.)
24"	6,500
30"	7,400
36"	8,400
42"	9,300
48"	10,100

## Approved for Production

Project: \_\_\_\_\_

Date: \_\_\_\_\_

Quantity: \_\_\_\_\_

By: \_\_\_\_\_



C.R. Barger & Sons, Inc.  
P.O. Box 370 - Kingston TN 37763  
Phone 888.882.5860 - BargerAndSons.com

### Specifications

**Concrete:** 5,000 psi minimum strength (28 day)  
**Reinforcement:** ASTM C 913 Latest Edition

## 48" W x 48" L Area Drain, Curb Inlet, Catch Basin & General Box

Date: 4.152010

Drawn By: Eric Barger

Approx. Vault Weight: See chart