

Top View

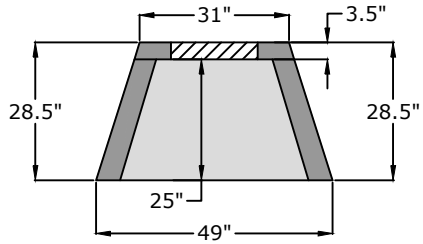

Hole Dia. (in.)	Weight (lb.)
8"	885
10"	877
12"	866
16"	840

Front View

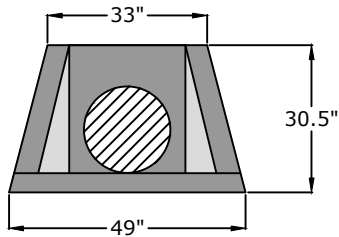

Side View

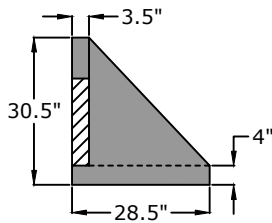

**Approved for Production**

Project: \_\_\_\_\_

Date: \_\_\_\_\_

Quantity: \_\_\_\_\_

By: \_\_\_\_\_

**BARGER**  
**PRECAST**

**Specifications**

**Concrete:** 5,000 psi minimum strength (28 day)

**Headwall Extra Small**

C.R. Barger & Sons, Inc.  
P.O. Box 370 - Kingston TN 37763  
Phone 888.882.5860 - BargerAndSons.com

Date: 11.022017

Drawn By: Eric Barger

Approx. Weight: See above